



Master Controller 6 channel

TRSX-MC6



The TRSX-MC6 Master Controller allows the control of up to 6 individual lanes.

Features

1. 6 front buttons: Go, Back, Stop, and 3 intermediate stopping points user-programmable
2. Allows the setup of range limits so the carrier will self-stop at the pre-determined limits, without hitting the end of the rail
3. It has 3 intermediate stopping points, user-programmable

Functions

1. Pairing/Unpairing the Controller

- a. Press and hold for 3s the Reset button on the motor (RED light comes ON)
- b. Select the desired channel on the controller (1 to 6)

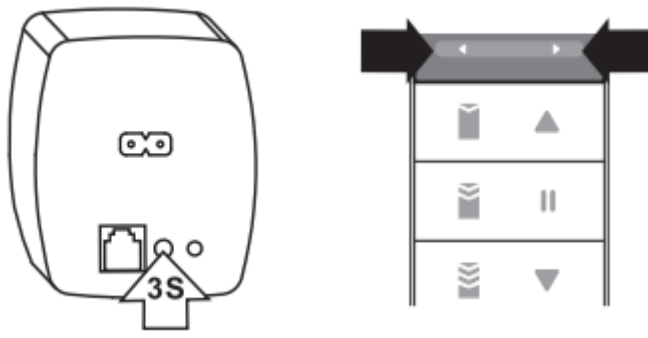

- c. Press the Reset button on the controller (remove the battery cover, press the one on the left side) (motor RED light blinks)

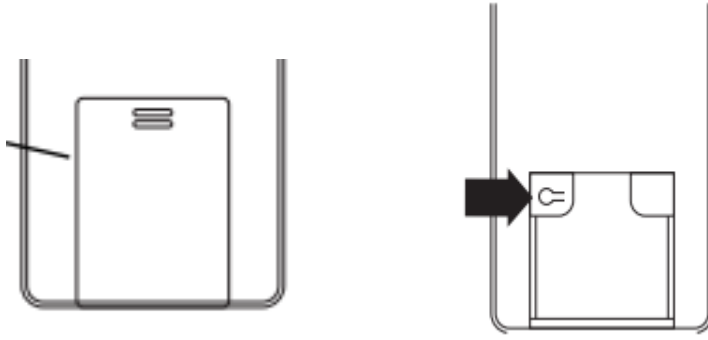

- d. Press the motor Reset button to confirm, 1 more time. RED light stops blinking.

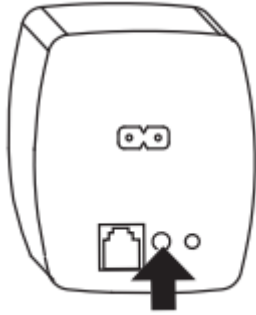

- e. To unpair, Press and Hold the motor Reset button for 3s until RED light comes ON, then release the button and press again for 7s.

Attention: This process will clear all memory and also clears all limits.

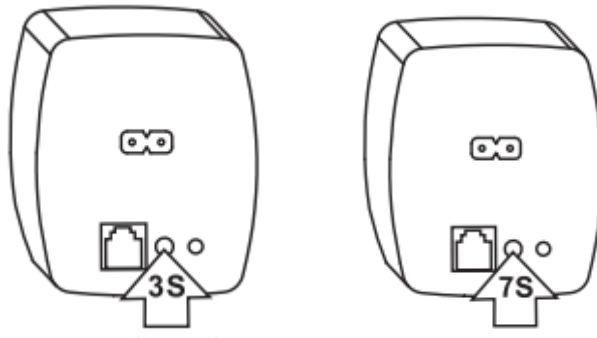

2. Setting the Limits

- a. Clear the motor of potential pre-existing limits by Press & Hold the controller Reset and Stop buttons for 5s. Motor will vibrate at the end of 5s period.

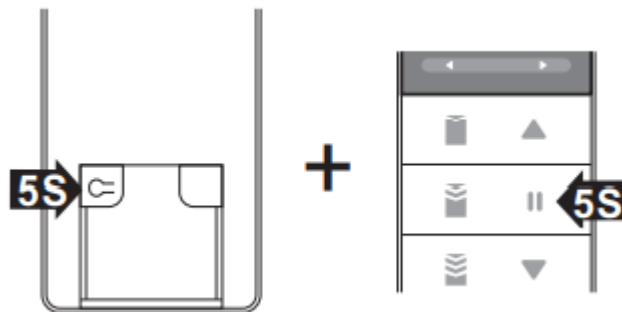

b. Setting Far-End (GO) limit

- i. Send the carrier to the desired position
- ii. Press & Hold the controller Reset and GO buttons for 5s. Motor will vibrate at the end of 5s period.
- iii. Red Light on the motor will come ON
- iv. Confirm by pressing the motor Reset button



c. Setting Back (Home) limit

- i. Same procedure as above but press instead the BACK button on the controller.

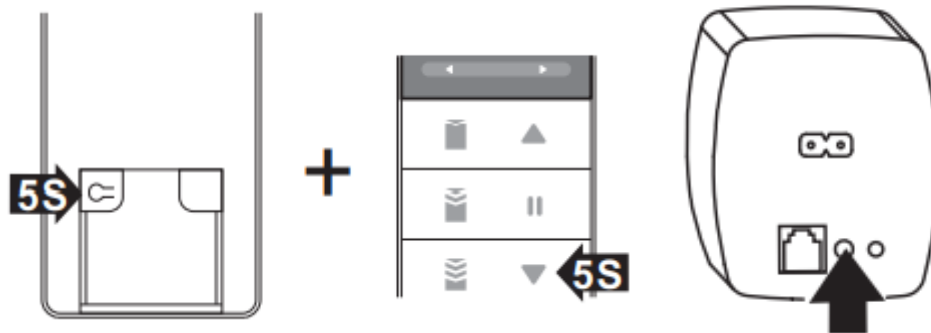

3. Setting intermediate points

a. Example: Stopping at 25% of the length.

- i. Move the carrier in desired position.
- ii. Press & Hold the controller Reset button then the corresponding 25% button.

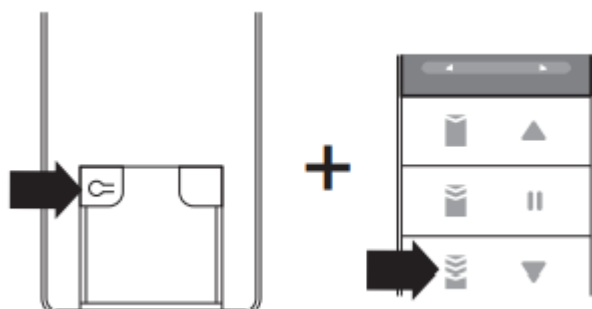

b. Example: Stopping at 50% of the length

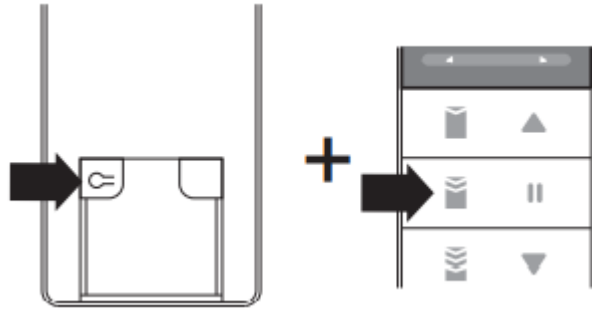

c. Example: Stopping at 75% of the length

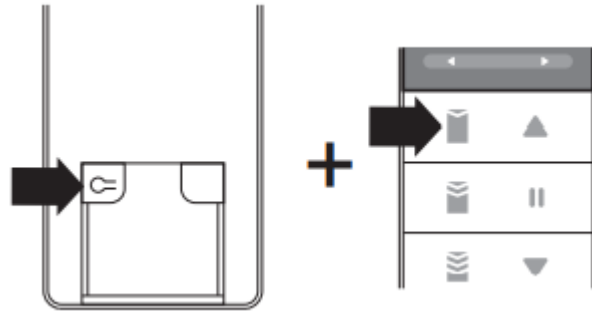

4. Modify the intermediate points

- a. Repeat the above procedure

5. Change motor direction

- a. Press & Hold the Motor reset button for 3s until RED light come ON
- b. Press shortly the Channel Selection and Stop button together
- c. Motor RED light starts blinking
- d. Press the Motor Reset button 1 more time to confirm.

