



MEDIUM DUTY TARGET RETRIEVING KIT

Rev 12

SIMPLE & AFFORDABLE

STS is dedicated to provide the most **AFFORDABLE** and **TECHNOLOGICALLY ADVANCED** solution for the target shooting enthusiasts eager to build their own target retrieval system, being private, home-based, or commercial. We offer complete target retrieval systems, bullet traps, target monitoring cameras and other advanced indoor range equipment and solutions at an **EXCEPTIONAL PRICE SAVINGS** and **QUALITY** compared to other market offerings.



Component List per 1 lane:

No	Part Number	Description	QTY	Notes	Pic
1	TRSX-R1	Heavy-Duty Aluminum Rail supplied in 5, 6, or 7 Ft segments	According to length ordered		
2	TRSX-CM1	Rail Ceiling Mounting	2 every 5Ft	Total qty based on distance	
3	TRSX-RJ1	Rail Joint	1 every 2 segments	Total qty based on distance	
4	TRSX-RE1	Drive End Unit	2		
5	TRSX-BT12	Dura Belt	2 x track length + 5"	Total length based on distance	
6	TRSX-36024V	Motor Kit Wireless Controller	1	24VAC/DC with 110VAC adapter	
7	TRSX-TC2	Target Carrier	1	Includes metal arm and accessories	
8	TRSX-SB10	Swing Bar	1	Dura Plastic, 90-degree holes	
9	TRSX-TH2	Target Holder	1	Corrugated Plastic	
10	TRSX-WT1	Wired Controller, Water Resistant	1		
11	TRSX-24V2ADC	Motor Power Supply	1		
12	TRSX-GBG1	Metal Cover End of Rail	1		
13	TRSX-GUIDE	Instructions Set (Motor Manual & TRS Guide)	1	Included in Kit or download from website	

Installation Steps

Note: Some components highlighted in the pictures below might look a bit different in reality, as we constantly try to improve our line

Step 1: Install the rails by installing first the ceiling mounts into first segment, twist to secure them

Step 2: Install half of the rail jointer needed to connect with the next segment and secure it loosely in place.

Step 3: Lift the whole assembly up and continue with next segment until all done.

Step 4: Check for rail gaps and tighten all the mounting screws

Step 5: Measure and cut the belt

Belt length= 2 Track Length + 5" (13cm)

Step 6: Thread the transmission belt into the first driver box unit



Step 7: Attach one of the carrier rollers to the belt, insert it inside the track and pull the belt all the way to the other side of the track



Step 8: Re-attach the carrier roller and insert inside the rail. Insert the first optional rail stopper and attach the gear box to the rail.



Step 9: On the other side, drive the belt through the second gear box, attach it to the second roller set and insert it inside the rail

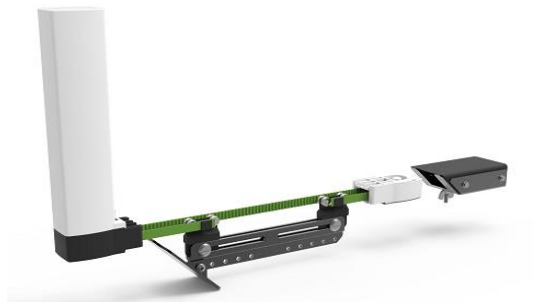

Step 10: With the 2 roller carriers inserted, insert the second optional rail stopper, attach the second gear box to the rail and bring the 2-carrier roller sets together



Step 11: Attach the carrier metal body using the provided screws and adjust the belt tension to ensure the 2 belt ends are reasonably tight (not too tight)



Step 12: Install the optional carrier bullet deflector



Step 13: Run the carrier by hand and ensure that it runs smoothly and there are no obstructions, especially in between the rails

Step 14: Install the ceiling mounts into the tracks, twist to secure them, lift the whole assembly using additional help and mount it on the ceiling



Step 15: Install the Motor (see also the motor manual for more details)



Step 16: Install the Swing Bar and Target Holder



Step 17: Connect power & verify movement

Connect the power to the motor and use the wireless controller to activate the motor or to program the motor's advanced functions.



Track Maintenance:

Remove the metal cover screws, gear flange and the stopper (if installed) to access, lubricate or replace the gear.

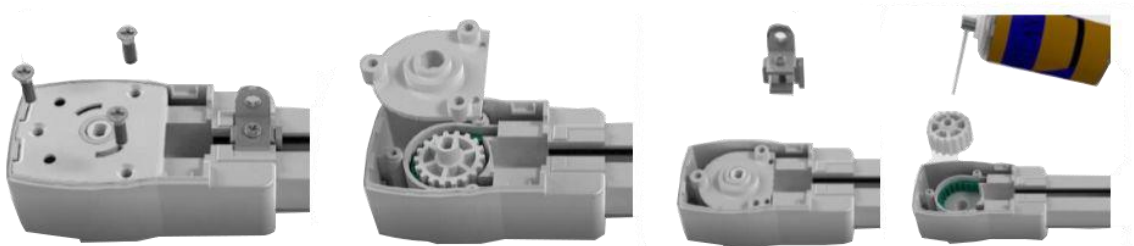

Tel: (800) 556-3162

Sales: sales@supertargetsystems.com

Technical Support: support@supertargetsystems.com

2055 Comprehensive Dr. | Aurora, IL – 60505

www.supertargetsystems.com

Thank You for your business!